

Rod Seals

GNY

(Metric Size)

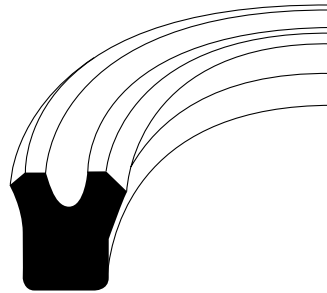

GNY

Material	Pressure (Bar)	Temp. (°c)	Speed (m/s)
NBR	175 (250)	-30 +100	1 (0.5)

- High wear resistance.
- Radial force resistance.
- Improve sealing performance for good elastic seal materials.

Installation Recommendation

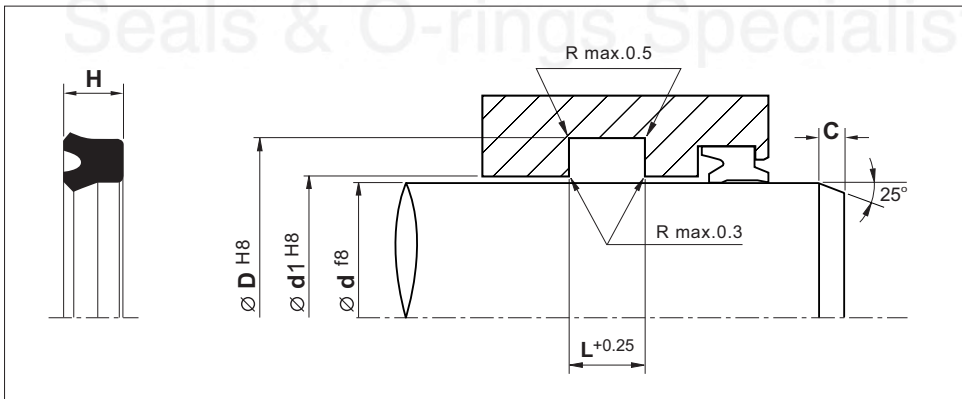

Surface roughness	Ra	Rt	Chamfers	
Sliding surface	≤ 0.3 μm	≤ 4 μm	d	C
Surface of housing	≤ 1.8 μm	≤ 10 μm	18-28	3.5
Sides of housing	≤ 3.0 μm	≤ 16 μm	28-45	4.0
			45-90	5.0
			90-180	6.0

Rubber U-Cup - GNY



(Metric Size)

Rod Dia.	Groove Dia.	Seal Height	Groove Width		Diameter	Reference (For order processing)
d	D	H	L	L1*	d1	
18.0	26.0	5.0	6.0	7.5	18.5	GNY-018
20.0	28.0	5.0	6.0	7.5	20.5	GNY-020
22.0	30.0	5.0	6.0	7.5	22.5	GNY-022
25.0	33.0	5.0	6.0	7.5	25.5	GNY-025
28.0	36.0	5.0	6.0	7.5	28.5	GNY-028
30.0	40.0	6.0	7.0	9.0	30.5	GNY-030
32.0	42.0	6.0	7.0	9.0	32.5	GNY-032
35.0	45.0	6.0	7.0	9.0	35.5	GNY-035
36.0	46.0	6.0	7.0	9.0	36.5	GNY-036
40.0	50.0	6.0	7.0	9.0	40.5	GNY-040
45.0	55.0	6.0	7.0	9.0	45.5	GNY-045
50.0	63.0	8.0	9.0	11.5	50.5	GNY-050
55.0	68.0	8.0	9.0	11.5	55.6	GNY-055
56.0	69.0	8.0	9.0	11.5	56.6	GNY-056
60.0	73.0	8.0	9.0	11.5	60.6	GNY-060
63.0	76.0	8.0	9.0	11.5	63.6	GNY-063
65.0	78.0	8.0	9.0	11.5	65.6	GNY-065
70.0	85.0	9.0	10.0	12.5	70.6	GNY-070
75.0	90.0	9.0	10.0	12.5	75.6	GNY-075
80.0	95.0	9.0	10.0	12.5	80.6	GNY-080
90.0	105.0	9.0	10.0	12.5	90.6	GNY-090
100.0	120.0	12.0	13.0	16.0	100.6	GNY-100
110.0	130.0	12.0	13.0	16.0	110.6	GNY-110
125.0	145.0	12.0	13.0	16.0	125.7	GNY-125
140.0	160.0	12.0	13.0	16.0	140.7	GNY-140
160.0	180.0	12.0	13.0	16.0	160.7	GNY-160
180.0	200.0	12.0	13.0	16.0	180.7	GNY-180

* L1 Groove for GNY used with 1 back up ring can stand pressure up to 250 Bar