

Piston Seals (Double Acting)

SMM

(Metric Size)

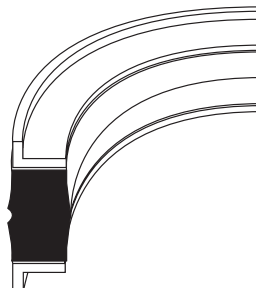

SMM

| Material | Pressure (Bar) | Temp. (°C) | Speed (m/s) |
|----------|----------------|-------------|-------------|
| NBR+POM | 400 | -30 +120 | 0.8 |

- Excellent sealing effect in combination with good dynamic and static friction behavior.
- Good abrasion resistance.
- Closed or split installation groove.
- For medium duty application.

Installation Recommendation

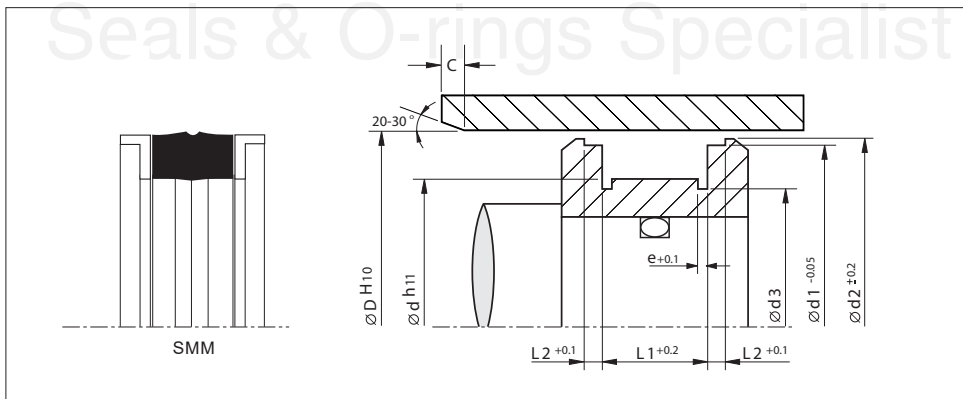

Surface roughness

Ra

Rt

Chamfers

| | | |
|--------------------|----------|---------|
| Sliding surface | ≤ 0.3 µm | ≤ 4 µm |
| Surface of housing | ≤ 1.8 µm | ≤ 10 µm |
| Sides of housing | ≤ 3.0 µm | ≤ 16 µm |

| D | C |
|---------|-----|
| < 60 | 4.0 |
| 60-120 | 5.0 |
| 120-180 | 6.5 |
| 180-250 | 7.5 |

Compact Seal

(Metric Size)

| Bore Dia. | Groove Dimensions | | | | | | | Reference |
|-----------|-------------------|------|-----|-------|-------|------|-----|-------------|
| | D | d | L1 | L2 | d1 | d2 | d3 | |
| 25.0 | 17.0 | 13.5 | 3.2 | 21.0 | 24.4 | 14.0 | 2.1 | SMM 025-017 |
| 30.0 | 22.0 | 13.5 | 3.2 | 26.0 | 29.4 | 19.0 | 2.1 | SMM 030-022 |
| 32.0 | 24.0 | 15.5 | 3.2 | 28.0 | 31.4 | 21.0 | 3.1 | SM 032-024 |
| 35.0 | 27.0 | 15.5 | 3.2 | 31.0 | 34.4 | 24.0 | 3.1 | SM 035-027 |
| 40.0 | 32.0 | 15.5 | 3.2 | 36.0 | 39.4 | 29.0 | 3.1 | SM 040-032 |
| 45.0 | 37.0 | 15.5 | 3.2 | 41.0 | 44.4 | 34.0 | 3.1 | SM 045-037 |
| 50.0 | 38.0 | 20.5 | 4.2 | 46.0 | 49.4 | - | - | SM 050-038 |
| 55.0 | 43.0 | 20.5 | 4.2 | 51.0 | 54.4 | - | - | SM 055-043 |
| 60.0 | 48.0 | 20.5 | 4.2 | 56.0 | 59.4 | - | - | SM 060-048 |
| 63.0 | 51.0 | 20.5 | 4.2 | 59.0 | 62.4 | - | - | SM 063-051 |
| 65.0 | 53.0 | 20.5 | 4.2 | 61.0 | 64.4 | - | - | SM 065-053 |
| 70.0 | 58.0 | 20.5 | 4.2 | 66.0 | 69.4 | - | - | SM 070-058 |
| 75.0 | 63.0 | 20.5 | 4.2 | 71.0 | 74.4 | - | - | SM 075-063 |
| 80.0 | 66.0 | 22.5 | 5.2 | 76.0 | 79.4 | - | - | SMM 080-066 |
| 90.0 | 76.0 | 22.5 | 5.2 | 86.0 | 89.4 | - | - | SM 090-076 |
| 100.0 | 86.0 | 22.5 | 5.2 | 96.0 | 99.4 | - | - | SM 100-086 |
| 110.0 | 96.0 | 22.5 | 5.2 | 106.0 | 109.4 | - | - | SM 110-096 |
| 120.0 | 106.0 | 22.5 | 5.2 | 116.0 | 119.4 | - | - | SM 120-106 |
| 125.0 | 108.0 | 26.5 | 7.2 | 121.0 | 124.4 | - | - | SM 125-108 |
| 140.0 | 123.0 | 26.5 | 7.2 | 136.0 | 139.4 | - | - | SM 140-123 |
| 150.0 | 133.0 | 26.5 | 7.2 | 146.0 | 149.4 | - | - | SM 150-133 |
| 160.0 | 143.0 | 26.5 | 7.2 | 156.0 | 159.4 | - | - | SM 160-143 |
| 180.0 | 163.0 | 26.5 | 7.2 | 176.0 | 179.4 | - | - | SM 180-163 |
| 200.0 | 180.0 | 31.5 | 9.2 | 196.0 | 199.4 | - | - | SM 200-180 |
| 220.0 | 200.0 | 31.5 | 9.2 | 216.0 | 219.4 | - | - | SM 220-200 |
| 250.0 | 230.0 | 31.5 | 9.2 | 246.0 | 249.4 | - | - | SM 250-230 |

* For order processing, the computer code will be
e.g. CS 025-017 SMM